

Archive hall

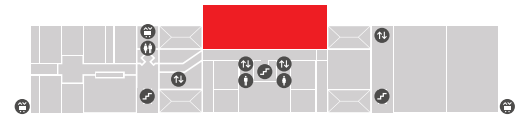

Floor 2



m²	1200	Characteristics
m	60 × 20,5	
m	6,80	
	Wooden floor	
	1200	Air-conditioner
	834	Possibility of total blackout
	183	Soundproofing
	204	Excellent acoustics
	1200	Sectored light system and with flux regulation
	1500	Rooms for catering support
		2 passenger lifts
		Rooms for dressing rooms and backoffice
		Possibility of placing a non-soundproof white curtain on a beam
		Electric power: see plan
		Internet: wireless and 2 fixed access points (see plan)

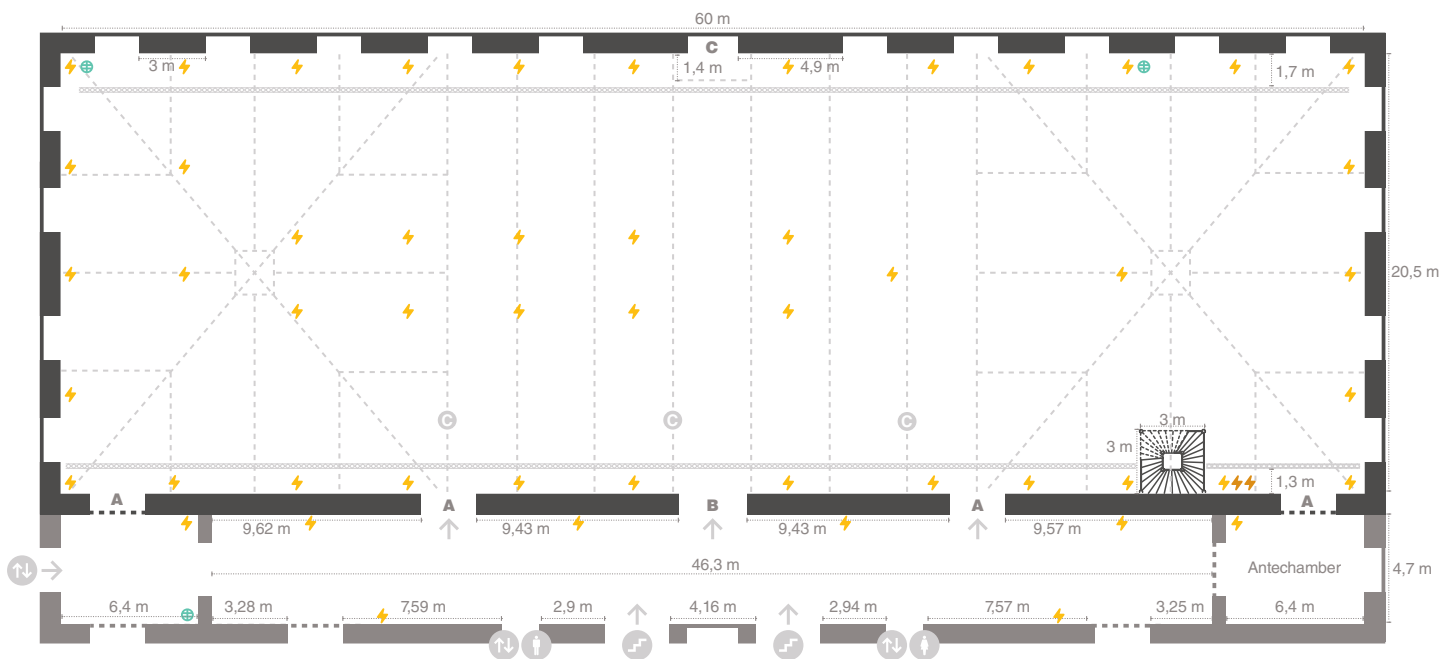

- Access
- Wooden beams
- C - Beams for curtain
- Truss structure
- 63 A three-phase socket
- 16 A single-phase socket
- Internet socket (RJ45)

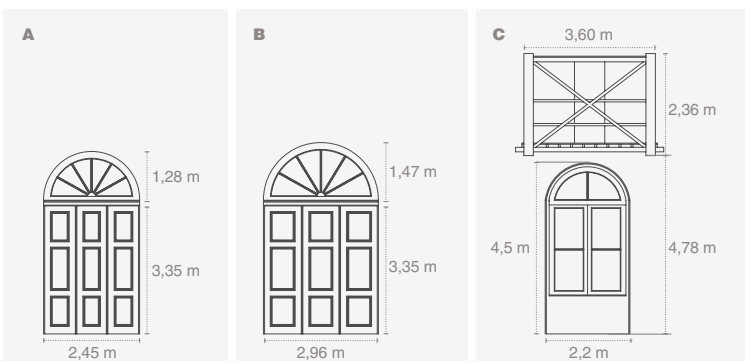

⊘ It is forbidden to apply adhesive or any other fixing system that damages the floor. Please, use paper tape before any other type of tape.

It is forbidden to stick any kind of object on the walls or beams.

! The maximum capacities of the rooms have been calculated with the greatest use of space in mind, so they may vary depending on the layout chosen.

The suspension of infrastructures, such as truss, lighting, projection, sound systems, and others must always be pre-approved by the Congress Centre.

Be careful when passing heavy materials (pallet trucks, lifting platforms, etc.) over floor boxes.

The facilities must be handed over in the same conditions as before.